

CHECK VALVES



BASIC DESIGN : BS 1868 / ASME B16.34

FACE-TO-FACE : ASME B16.10

FLANGES : UP TO 24" ASME B16.5
FROM 26" ASME B16.47

BUTTWELD ENDS : ASME B16.25

MARKING : MSS-SP-25

INSPECTION AND TESTING : API 598

CHECK VALVE

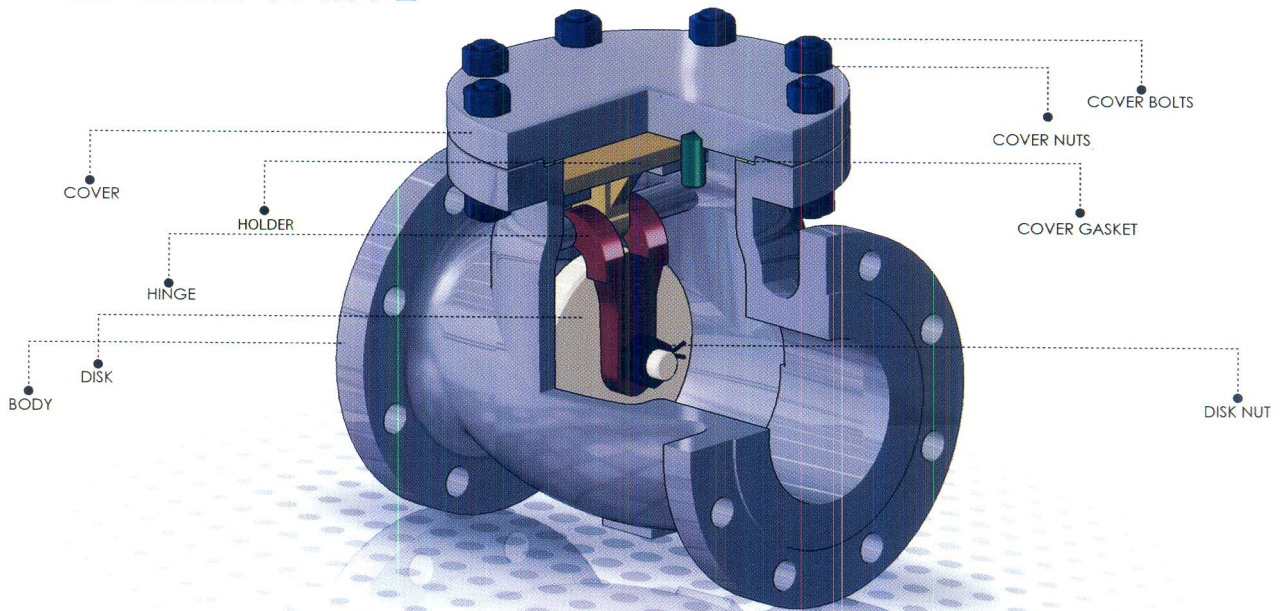

	WCB	LCB	WC6	WC9	C5	CF8	CF8M
BODY	A216 GR.WCB	A352 GR.LCB	A217 GR.WC6	A217 GR.WC9	A217 GR.C5	A351 GR.CF8	A351 GR.CF8M
COVER	A216 GR.WCB	A352 GR.LCB	A217 GR.WC6	A217 GR.WC9	A217 GR.C5	A351 GR.CF8	A351 GR.CF8M
COVER BOLTS	A193 GR.B7	ASTM A320 GR.L7	ASTM A193 GR.B16	ASTM A193 GR.B16	ASTM A193 GR.B16	ASTM A193 GR.B8	ASTM A193 GR.B8
COVER NUTS	A194 GR.2H	ASTM A194 GR.4	ASTM A194 GR.4	ASTM A194 GR.4	ASTM A194 GR.4	ASTM A194 GR.8	ASTM A194 GR.8
COVER GASKET CLASS 150	SOFT STEEL	TYPE 304 SS	TYPE 304 SS	TYPE 304 SS	TYPE 304 SS	TYPE 316 SS	TYPE 316 SS
COVER GASKET CLASS 300 & 600	SPIRAL 316 SS+GRAPHITE	SPIRAL 316 SS+GRAPHITE	SPIRAL 316 SS+GRAPHITE	SPIRAL 316 SS+GRAPHITE	SPIRAL 316 SS+GRAPHITE	SPIRAL 316 SS+GRAPHITE	SPIRAL 316 SS+GRAPHITE
COVER GASKET CLASS 900 & UP	STEEL RING	304 SS RING	304 SS RING	304 SS RING	304 SS RING	316 SS RING	316 SS RING
HINGE	A216 GR.WCB	A352 GR.LCB	A217 GR.WC6	A217 GR.WC9	A217 GR.C5	A351 GR.CF8	A351 GR.CF8M
DISK NUT	A194 GR.2H	ASTM A194 GR.4	ASTM A194 GR.4	ASTM A194 GR.4	ASTM A194 GR.4	ASTM A194 GR.8	ASTM A194 GR.8
HOLDER	A216 GR.WCB	A352 GR.LCB	A217 GR.WC6	A217 GR.WC9	A217 GR.C5	A351 GR.CF8	A351 GR.CF8M

TRIM NUMBER	SEAT RING SURFACE	DISK SURFACE	PIN
1	F6	F6	F6
2	F304	F304	F304
5	STELLITED	STELLITED	F6
8	STELLITED	F6	F6
9	MONEL	MONEL	MONEL
10	F316	F316	F316
12	STELLITED	F316	F316
13	ALLOY 20	ALLOY 20	ALLOY 20

CHECK VALVES ASME CLASS 150

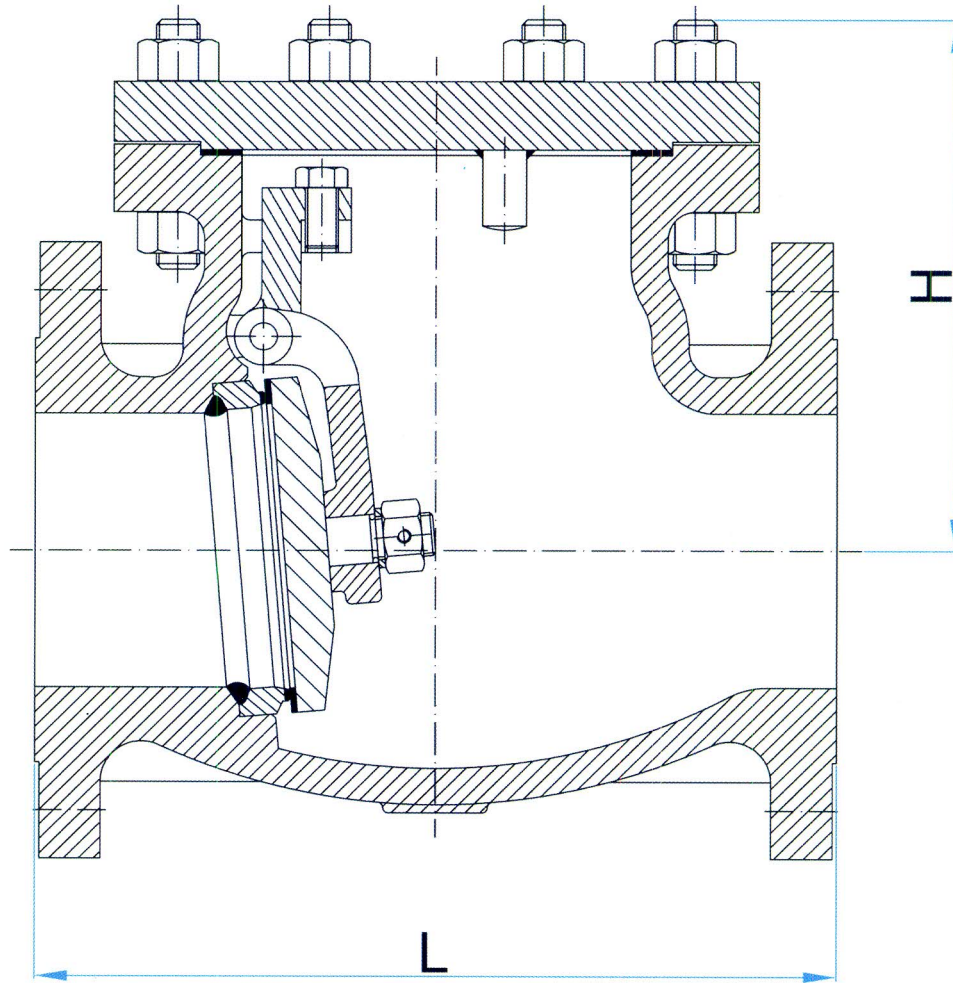

DN (mm)	50	65	80	100	150	200	250	300	350	400	450	500	600	700	750	800	900	1050	1200
NPS (inch)	2	2 1/2	3	4	6	8	10	12	14	16	18	20	24	28	30	32	36	42	48
L (RF, BW) (mm)	203	216	241	292	356	495	622	699	787	864	978	978	1295	1448	1524	1727	1965	2261	2566
H (mm)	170	182	186	214	260	300	348	400	452	481	539	600	682	940	985	1260	1380	1470	1645
WEIG HT (KG)	15	26	27	42	75	124	200	310	428	555	775	835	1300	1650	2000	2450	3150	5000	6700